

Savvy Off Road Trail Doors TJ/LJ 1997-2006

Thank you for the purchase of our Trail Doors. We have made these from 6061-T6 and reinforced them with a stiffener at the top that doubles as a comfortable armrest and one at the bottom to give you a design that combines high strength and light weight. These are the perfect solution for those times when you need a bit more comfort and would like to leave your OEM doors protected in a safe place. Rear latch doors are difficult to open and our solution mimics the OEM doors with the unique remote front lever handle and rear latch knob. The use of a quality rotary latch on the inside affords a rattle-free experience and protects them from trail damage with an uncluttered look.

Enclosed you will find a set of instructions that will enable you to install the Trail Doors with a minimum of fuss and little more than basic hand tools. If you attempt the install and find yourself not understanding what needs to be done, please contact Savvy Off Road with your technical issue.

Please take the time to read these instruction and familiarize yourself with the hardware parts list before attempting your installation. The instructions are lengthy, but are written to provide you with a step-by-step guide to install the Savvy Trail Doors with minimal issues.

Parts and tools needed for installation- Outside of the parts supplied in the kit, you will need personal safety equipment, assorted hand tools, allen wrenches, torx bits and a phillips screw driver to complete the installation.

Cleaning and Painting - Depending on your climate and environment you may choose to paint your Trail Doors. Cleaning with brake cleaner or mineral spirits is recommended to remove the material ink markings on door skins as well as good prep if painting. Should you choose to paint your Trail Doors, it is best to do so while fully disassembled.



Hardware Parts List

Hardware	Quantity
10 - 24 x 5/8" Flat Head Phillips Screw (N)	20
10 - 24 Flange Nuts	20
1/4" - 20 x 3/4" HHCS (K)	2
1/4" - 20 x 5/8" HHCS (L)	14
1/4" - 20 x 3/4" BHSCS (M)	4
1/4" - 20 Nylock Nut	16
1/4" Washer	18
3/8" - 16 x 2 - 1/2" HHCS	4
3/8" - 16 Nylock Nut	4
Nylon Washer	2
Plastic Clips	2
Assembled Door Cable	2
2.5" Anti-Rattle Sleeve	1
Door Hinges	4
Door Handle Knobs (A)	2
Lower Door Braces (B)	2
Left Door Latch (C)	1
Left Arm Support (D)	1
Left Latch Bracket (E)	1
Left Door Handle (F)	1
Right Door Handle (G)	1
Right Door Latch (H)	1
Right Latch Bracket (I)	1
Right Arm Support (J)	1

HHCS = Hex Head Cap Screw
BHSCS = Button Head Socket Cap Screw

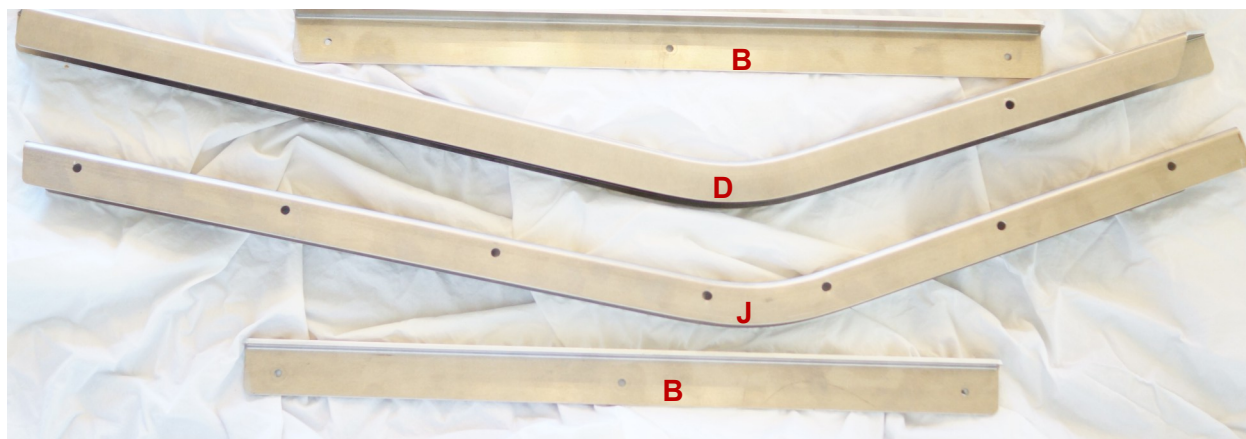
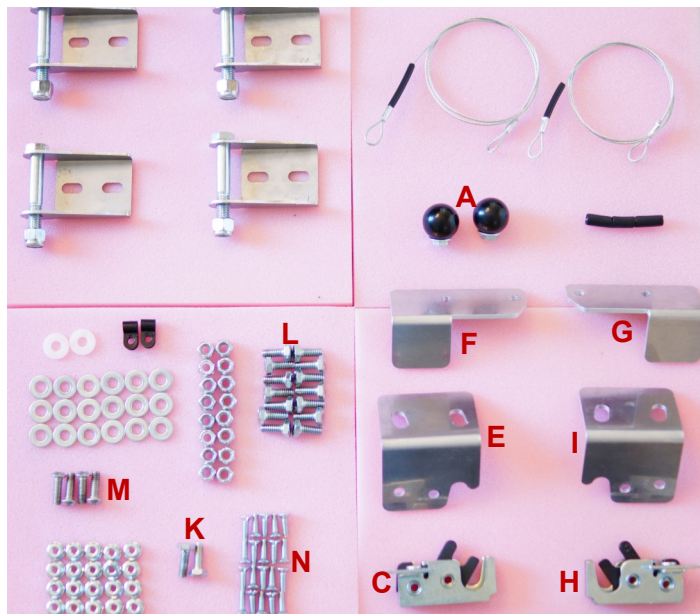

Step 1

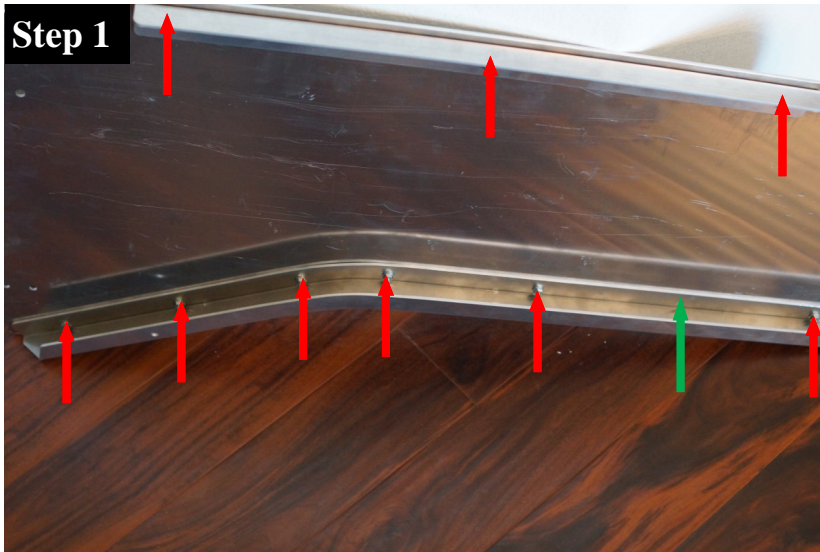

Starting on the Left Door organize the following components to assemble the Left Door.

- (1) Left Door Skin
- (1) Left Arm Support
- (1) Lower Door Brace
- (9) 10 - 24 x 5/8" Flat Head Philips Screw
- (9) 10 - 24 Flange Nuts

Assemble the Lower Door Brace and Left Arm Support to the Left Door using above listed Philips Screw and Flange Nuts as shown in the **red arrows**.

Please note there is one fastener that will be installed later when the door cable is routed. (**Green Arrow**)

Step 2

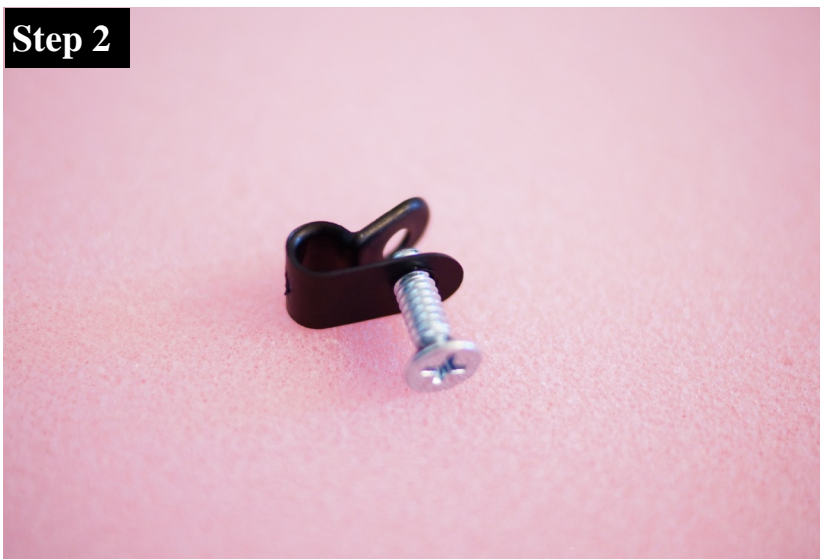

To aid the install of the Plastic Clip thread a 10 - 24 x 5/8" Flat Head Philips Screw through the plastic clip and remove.

Step 3

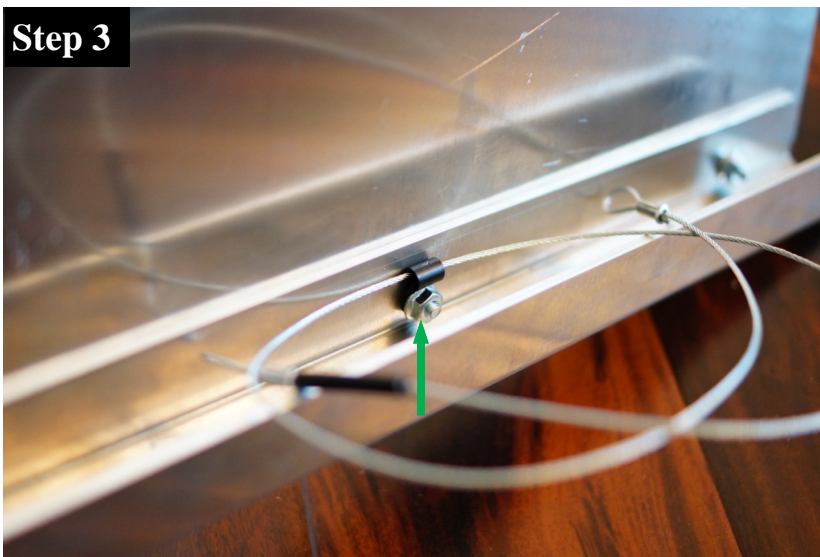

Slip the Door Cable through the Plastic Clip that you previously threaded such that the black plastic sleeve on the cable end loop is near where the door latch will be installed. Install a 10 - 24 x 5/8" Flat Head Philips Screw and 10 - 24 Flange Nut to secure the Door Cable.

Step 4



Now gather the following components for the Left Door Latch Assembly.

- (1) Left Door Latch
- (1) Left Door Latch Bracket
- (2) 1/4" - 20 x 3/4" BHSCS
- (2) 1/4" - 20 x 5/8" HHCS
- (2) 1/4" Washers
- (2) 1/4" - 20 Nylock Nuts

Step 5

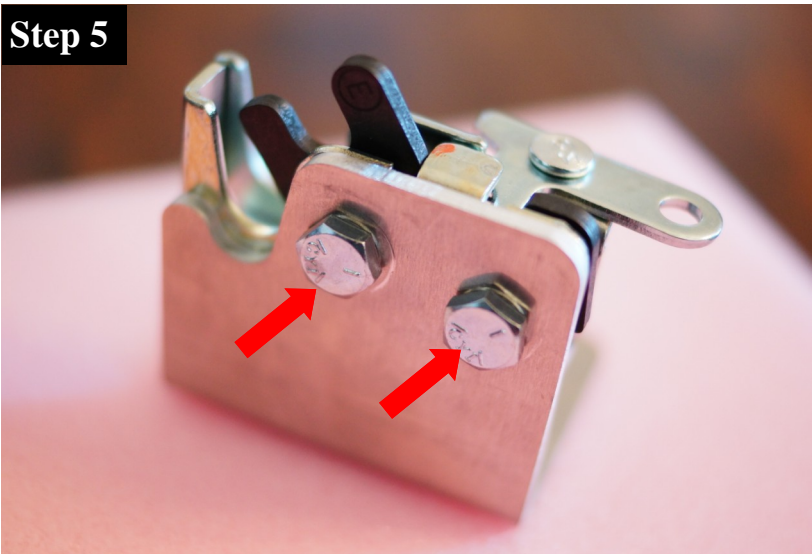

Assemble the Left Door Latch to the Left Door Latch Bracket using (2) 1/4" - 20 x 5/8" HHCS as shown in the **red arrows**.

Step 6

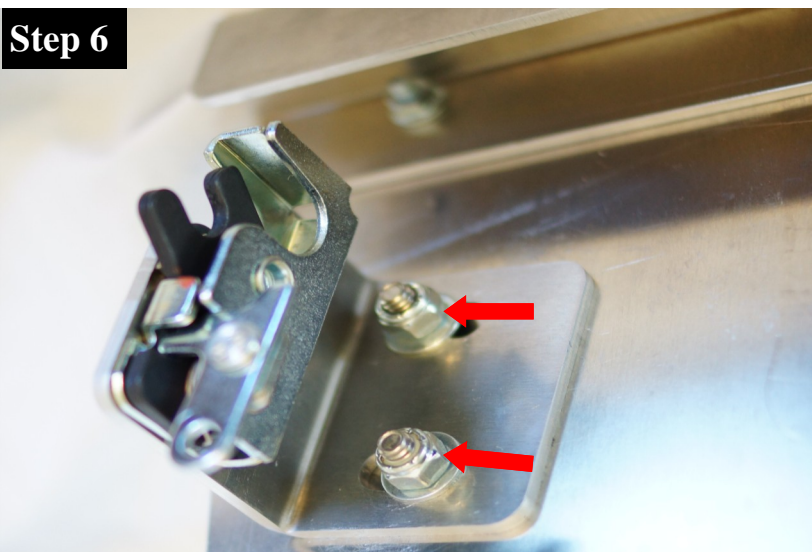

Loosely attach the Left Door Latch Bracket to the Left Door Skin using (2) 1/4" - 20 x 3/4" SHBS. The (2) 1/4" Washers and (2) 1/4" - 20 Nylock Nuts should be fastened such that the 1/4" Washers are on the Left Door Latch Bracket as shown.

Tighten both (2) 1/4" - 20 x 3/4" BHSCS but not snug. The tolerances for each Jeep Tub is different and this item will need to be adjusted to fit on your Jeep.

Step 7

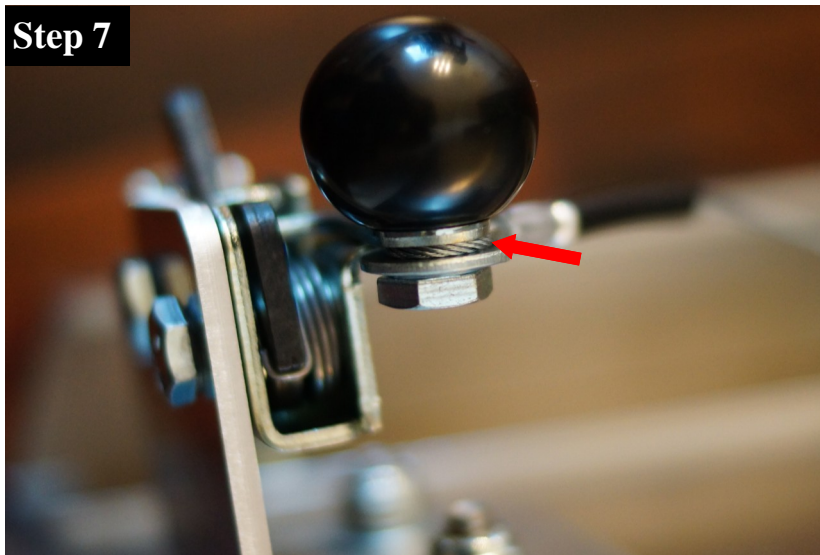

At this point the supplied Door Latch Knob should be installed as shown with the Door Cable between the Washer and Door Latch as illustrated in the **red arrow**.

Do not fully tighten as this will be adjusted so your Door Cable clears the moving arm of the Door Latch.

Step 8

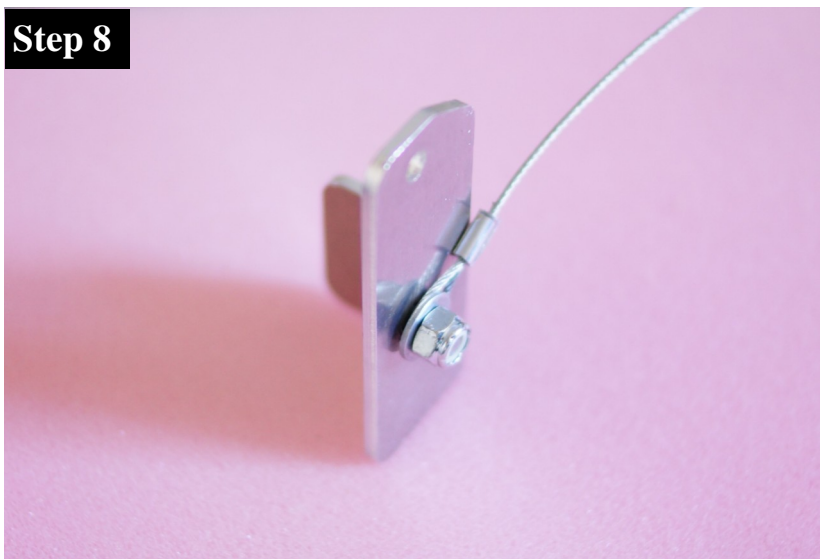

Assemble the Door Cable to the Left Door Handle with (1) 1/4" - 20 x 5/8" HHCS, (2) 1/4" Washers one on each side of the Door Handle and (1) 1/4" - 20 Nylock Nut.

Pay special attention that the Door Cable is between the Door Handle and 1/4" Washer. Do not fully tighten as the angle will need to be adjusted on final install.

Step 9



Note: Read entire step before installing.

Using (1) 1/4" - 20 x 3/4" HHCS, (1) 1/4" Washer, Nylon Washer and 1/4" - 20 Nylock Nut you will attach the Left Door Handle to the Left Arm Support. 1/4" Washer should be installed below the head of the 1/4" - 20 x 3/4" HHCS.

To ensure smooth operation of the Door Handle the Nylon Washer should be installed between the Left Arm Support and the Left Door Handle.

Tighten the 1/4" - 20 Nylock Nut to snug while allowing the Door Handle to rotate freely. You may need to loosen this fastener to allow Door Handle to move.

Step 10

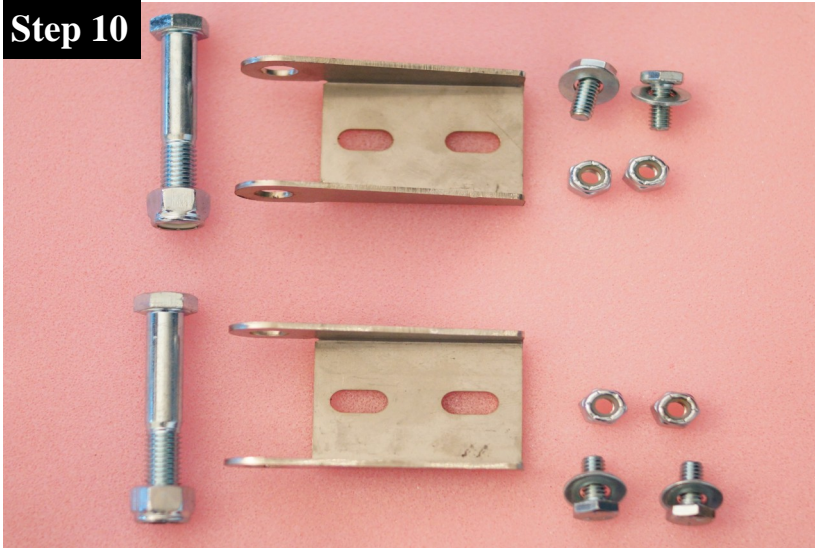

Gather the following components to assemble the Door Hinges to the Door Skin.

- (2) Door Hinges
- (2) 3/8" - 16 x 2 - 1/2" HHCS
- (2) 3/8" - 16 Nylock Nut
- (4) 1/4" - 20 x 5/8" HHCS
- (4) 1/4" - 20 Washers
- (4) 1/4" - 20 Nylock Nut

Step 11

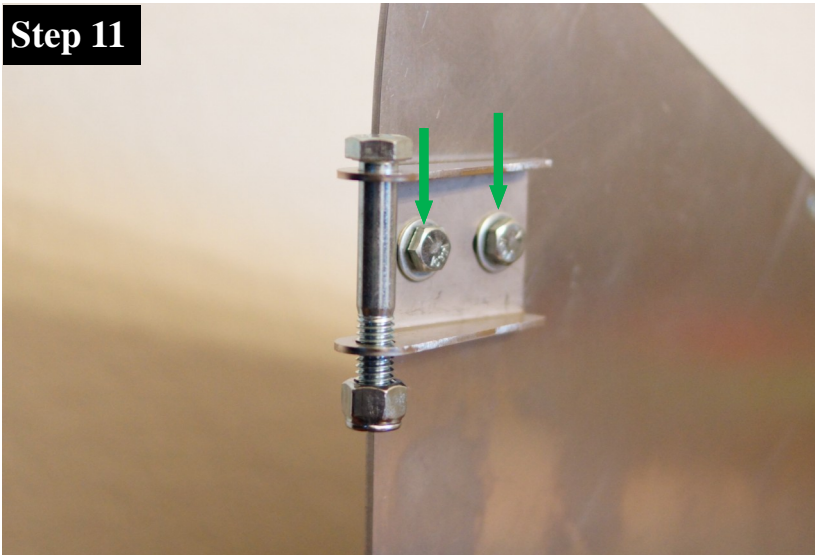

Assemble the Door Hinge to the Door Skin as shown. Note that the 1/4" Washers are below the head of the HHCS on the Door Hinge as shown in the **green arrows**.

Secure the (2) 1/4" - 20 x 5/8" HHCS with (2) 1/4" - 20 Nylock Nut for each Door Hinge and do not fully tighten. Leave enough adjustment in the Door Hinge for attachment to the Jeep tub.

Attach the second Door Hinge in the same fashion and do not fully tighten.

Step 12

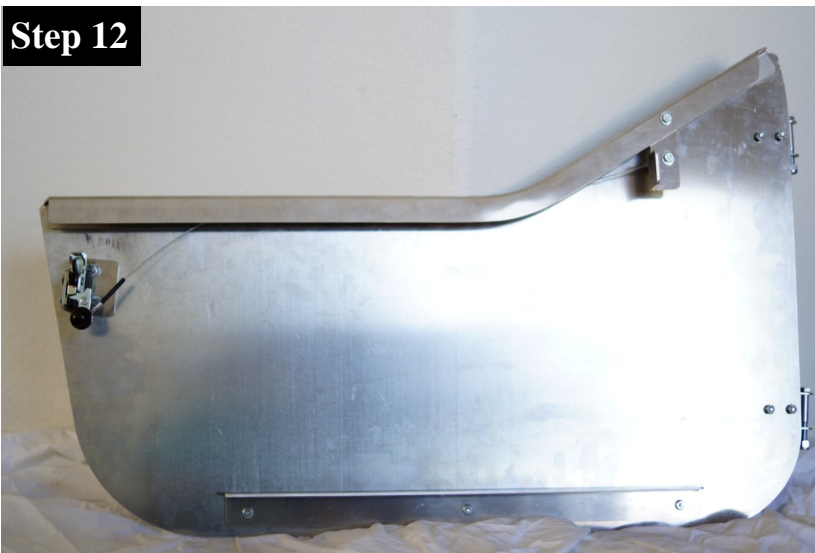

At this point the Left Trail Door is fully assembled and ready for install.

Repeat Steps 1 - 11 for assembly of the Right Door and proceed to Step 13.

Step 13



With both doors assembled you are now ready to install your Trail Doors on your Jeep.

Step 14



Working on the right side carefully remove your current doors.

Note: At this point your interior light might be on due to the Door Defeat Switches. You will need to determine if you are going to disable your interior lights by removing the door switch fuse or install Retaining Springs (available online) on your Door Defeat Switches.

Slide the assembled Right Door onto the tub mounts.

Slide the (2) 3/8" - 16 x 2 - 1/2" HHCS onto the tub mounts and pay special attention for adequate clearance on the Right Windshield Hinge as shown in the **red arrow**.

Step 15



At this point take the 2.5" Anti-Rattle Sleeve needs to be installed over your Tub Strikers (shown in red arrow).

Cut the 2.5" Anti-Rattle Sleeve in half and then create a slit that allows you to slip the Sleeve over the Door Striker. Doing this will eliminate and metal on metal contact between the Door Latch and the Tub Striker.

Please retain the remaining Anti-Rattle Sleeve to be installed on the Tub Striker on the other door installation.

Step 16

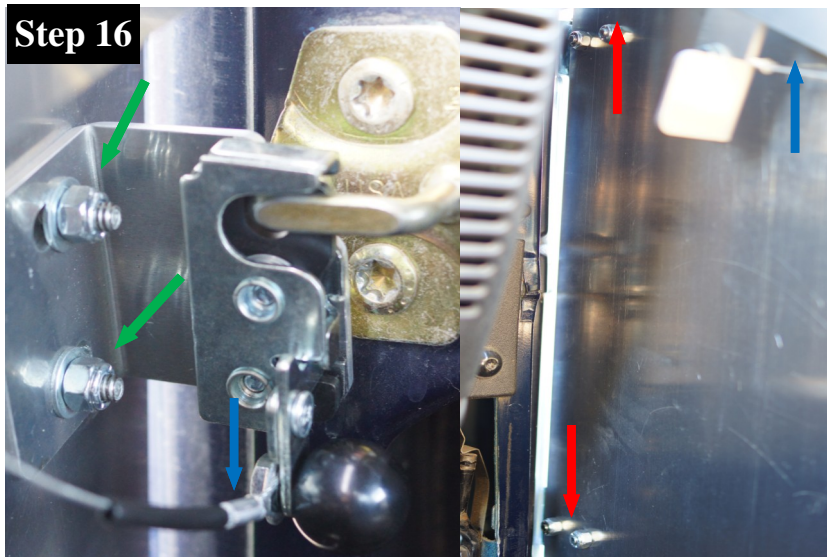

Fully close the Trail Door taking care to adjust the Door Latch to allow closure against the Tub Striker.

Now review the gap around the door and apply pressure against the door while tightening the Door Latch Bracket Fasteners shown by the **green arrow**.

Again with pressure against the door tighten the Hinge Bracket Fasteners as shown by the **red arrows**.

With the door fully open adjust and tighten the Door Cable as shown by the **blue arrows**. (also door cable angles show on Step 13)

Open and close the door several times to ensure smooth operation with no rattle. Adjusting the Tub Striker may be necessary to ensure rattle free operation.

Step 17



Now tighten the 3/8" - 16 Nylock Nuts that secure the Door Hinges to the Tub.

You are now complete with one of your Savvy Trail Door installation. Please proceed to the Step 18.

Step 18



Please repeat Steps 14 - 17 to install your Left Savvy Trail Door.

You have now completed your Savvy Trail Door installation!